

STYLE VLR/VHR or VLQ/VHQ 2000RA RIGHT ANGLE REDUCER

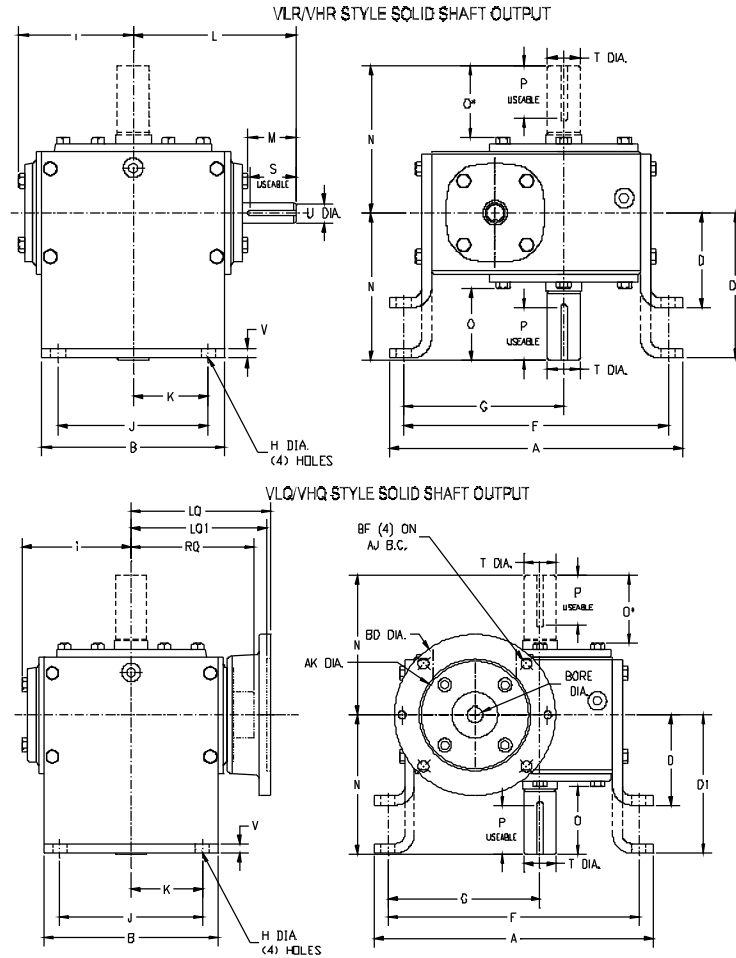

UNIT	A	B	D	D1	F	G	H	I	J	K	L	M	N	P**	O
2133	7.26	4.00	2.63	3.56	6.50	3.86	.38	2.13	3.00	1.50	3.82	1.32	4.00	3/16 X 1.50	1.97
2154	7.88	5.00	3.00	4.38	7.00	4.28	.44	3.25	4.00	2.00	4.35	1.25	4.31	3/16 X 1.50	1.90
2175	8.25	5.00	3.00	4.38	7.37	4.50	.44	3.33	4.00	2.00	4.45	1.42	4.33	3/16 X 1.38	1.83
2206	9.38	6.00	3.13	4.88	8.38	5.09	.50	3.72	4.88	2.44	4.82	1.42	4.69	1/4 X 1.44	2.12
2238	9.94	6.00	3.38	5.25	8.81	5.38	.50	3.82	4.88	2.44	5.51	1.93	5.07	1/4 X 1.75	2.38
2262	11.24	7.00	3.63	5.56	10.12	6.12	.56	4.38	5.75	2.88	6.07	1.87	5.63	1/4 X 2.00	2.75
2300	12.50	8.00	3.94	5.88	11.13	6.75	.56	4.71	6.00	3.00	6.57	1.87	6.75	1/4 X 2.25	3.46
2325	13.00	8.50	4.69	6.25	11.88	7.13	.56	5.02	6.13	3.06	6.76	1.98	7.06	3/8 X 2.62	3.51
2425	16.26	10.00	5.00	7.50	14.88	8.69	.69	5.77	7.88	3.94	9.57	3.65	8.12	1/2 X 3.06	4.26
2525	19.62	13.00	5.16	9.16	18.00	10.88	.78	7.40	10.00	5.00	10.88	3.48	9.06	1/2 X 3.50	4.36

** Keyway width by length

NEMA Motor C-Face Flange Locations

UNIT	S**	T	U Dia.	V	56C/140TC		180TC		210TC	
					RQ	LQ	RQ	LQ1	RQ	LQ
2133	1/8 x 1.44	0.625	.500	0.984	3.21	3.62	N/A	N/A	N/A	N/A
2154	3/16 x 1.50	0.750	.625	1.181	3.72	4.29	N/A	N/A	N/A	N/A
2175	3/16 x 1.50	0.875	.625	1.575	3.75	4.37	N/A	N/A	N/A	N/A
2206	3/16 x 1.50	1.000	.625	1.969	4.15	4.76	N/A	N/A	N/A	N/A
2238	3/16 x 1.75	1.125	.750	2.165	4.18	4.86	4.89	5.48	N/A	N/A
2262	3/16 x 1.75	1.250	.750	2.165	4.94	5.62	5.42	5.86	N/A	N/A
2300	3/16 x 1.75	1.250	.875	2.756	5.31	5.94	5.78	6.18	5.94	6.49
2325	3/16 x 1.75	1.500	.875	2.756	5.58	6.26	6.10	6.50	6.25	6.80
2425	1/4 x 2.88	1.875	1.250	3.150	6.15	6.54	6.42	6.97	6.42	6.97
2525	1/4 x 3.00	2.000	1.250	4.724	7.63	8.05	8.02	8.57	8.02	8.57

*** Keyway width by depth

NEMA Motor C-Face Mounting Dimensions

FRAME	AJ	AK	BD	BE	BE1	BF	BORE	KEYWAY****
56C	5.88	4.50	6.50	0.38	N/A	0.41	0.625	3/16 X 3/32
140TC	5.88	4.50	6.50	0.38	N/A	0.41	0.875	3/16 X 3/32
180TC	7.25	8.50	9.00	N/A	.50	0.53	1.125	1/4 X 1/8
210TC	7.25	8.50	9.00	N/A	.50	0.53	1.375	5/16 X 5/32

**** Keyway width by depth

STERLING
ELECTRIC, INC.